

## How To Adjust Tension in Scissor Arm to Eliminate Drifting

On the scissor arm, there are access panels near each joint on the underside of the scissor arm. If the scissor arm is drifting, you can tighten either link of the scissor arm depending on where the drifting is occurring. You can tighten the tension spring on the console side of Joint B (Arm Link Y), or arm Link X closest to Joint A (closest to tubehead).

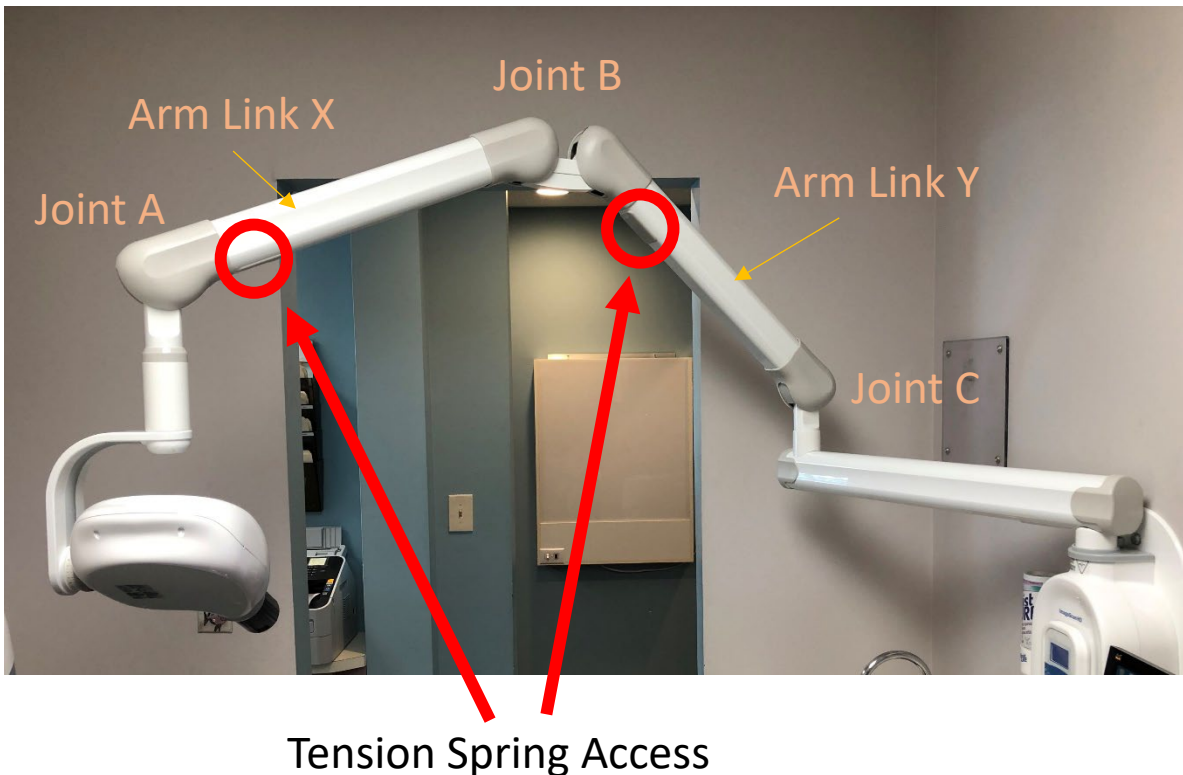

To access the tension spring, gently remove the access panel. When the outer access cover is removed, you will see a thin plastic cover behind the cables. Slide the plastic protective panel out of the way to reveal a cylinder with vertical slots.

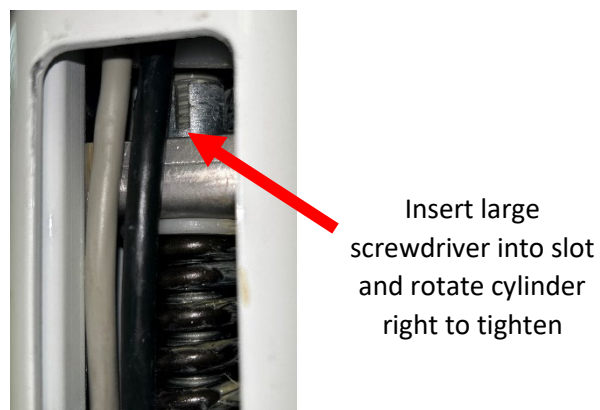
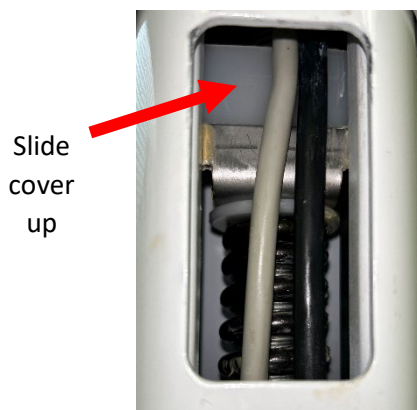



Using a large screwdriver, carefully tighten the slotted cylinder until desired tension is reached. Do this by sliding the tip of the screwdriver into the slot and then using it as a lever to move the slot (thereby turning the cylinder).

Note: sometimes turning this cylinder requires significant force in older units, so it may require a large screwdriver for a lot of leverage.